

Model	F401 Finisher	Volt/Hz	Date of Modification	Serial Number
Modified Article	Parts Catalog			
Reason for Modification	Parts Catalog Correction			

**1. Not Listed**

Please add the following part to your parts catalog.

P/N	Description	Parts Catalog		Fig. No.
		Index No.	Page	
A608 1136	Edging - 120 mm	* 25	21	1

\* New Index

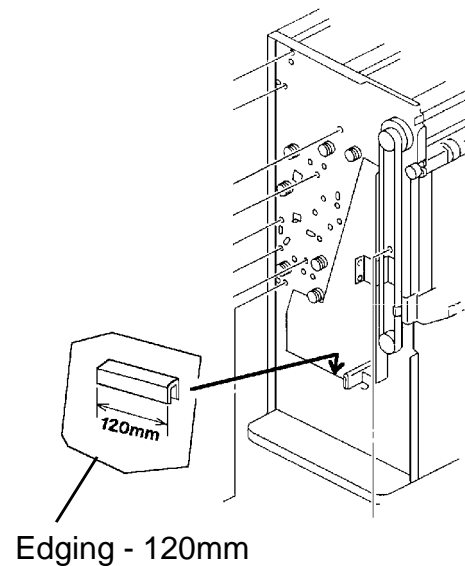

**Fig. 1**

*T. Inoue*  
T. Inoue, General Manager  
QAC 1st Field Information Dept.

MODEL NAME	V/Hz	DESTINATION	JAPAN PRODUCTION	
			CODE	SERIAL NUMBER
Savin SR900	120/60	U.S.A.	A608 - 15	
Ricoh SR900	120/60	U.S.A. etc.	A608 - 17	
	230/50	Europe etc.		
NRG SR900	120/60	U.S.A. , Canada etc.	A608 - 22	
	230/50	Europe etc.		
Infotec SR900	230/50	Europe	A608 - 26	

ISSUED ON: January 31, '97

<b>Model</b>	F401 Finisher	<b>Volt/Hz</b>	<b>Date of Modification</b>	<b>Serial Number</b>
<b>Modified Article</b>	Parts Catalog			
<b>Reason for Modification</b>	Parts catalog correction			

Please correct your parts catalog as follows:

Incorrect P/N	Correct P/N	Description	Q'ty Used	Parts Catalog	
				Index No.	Page
A379 4259		Positioning Fence Mylar	2	6	11
	A612 4259	Positioning Fence Mylar Rear	1	40	11
	A612 4258	Positioning Fence Mylar Front	1	41	11

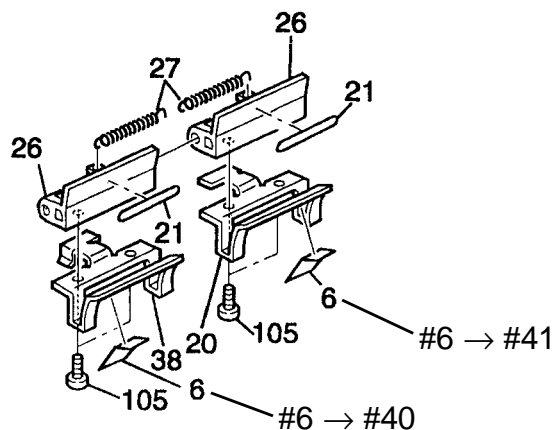

*T. Inoue*  
T. Inoue, General Manager  
1st Field Information Dept. QAC

MODEL NAME	V/Hz	DESTINATION	JAPN PRODUCTION	
			CODE	SERIAL NUMBER
Savin SR900	120/60	U.S.A.	A608 - 15	
Ricoh SR900	120/60	U.S.A., etc.	A608 - 17	
	230/50	Europe, etc.		
NRG SR900	120/60	U.S.A. , Canada, etc.	A608 - 22	
	230/50	Europe, etc.		
Infotec SR900	230/50	Europe	A608 - 26	

Model: F401 Finisher		Date: 28-Feb-97	No: 003	1/1
Modified Article: Parts Catalog			Prepared by: H. K.	
From: QAC 1st Field Information Dept.			Checked by: T. Inoue <i>T. Inoue</i>	
Reason for Modification:	<input checked="" type="checkbox"/> Parts catalog correction <input type="checkbox"/> Vendor change <input type="checkbox"/> To meet standards <input type="checkbox"/> To facilitate assembly <input type="checkbox"/> To improve reliability    (     ) <input type="checkbox"/> Part Standardization <input type="checkbox"/> Other			

## P/N Correction

Please correct the following part number in your parts catalog:

Incorrect part number	Correct part number	Description	Page	Index	Note
A612 4140	A612 6179	Lower Front Cover	5	12	

Model: Finisher for F401/411/421		Date: 15-Jun-97	No: 4
Modified Article: Stapler Guide Rail		Prepared by: M.Kitajima	
From: QAC 1st Field Information Dept.			
Reason for Modification:	<input type="checkbox"/> Parts catalog correction <input type="checkbox"/> Vendor change <input type="checkbox"/> To meet standards <input type="checkbox"/> To facilitate assembly <input type="checkbox"/> To improve reliability    (   ) <input checked="" type="checkbox"/> Part standardization <input type="checkbox"/> Other		

Old part number	New part number	Description	Qty	Int	Page	Index	Note
A3003732	A6974186	Stapler Guide Rail	1-1	O/O	13	33	

To standardize with other models, the above mentioned part has been changed.

			JAPAN PRODUCTION	
MODEL NAME	V/ Hz	DESTINATION	CODE	SERIAL NUMBER
Savin SR900	120/60	U.S.A.	A608 - 15	
Ricoh SR900	120/60	U.S.A. etc.	A608 - 17	
	230/50	Europe etc.		
NRG SR900	120/60	U.S.A. , Canada etc.	A608 - 22	
	230/50	Europe etc.		
Infotec SR900	230/50	Europe	A608 - 26	

Model: Finisher for F401/411/421/C-bird		Date: 31-Oct-99	No.: MA608005
Modified Article: Front/Rear Jogger Fence		Prepared by: F.Noguchi	
From: Technical Service Dept., GTS Division			
Reason for Modification:	<input type="checkbox"/> Parts catalog correction <input type="checkbox"/> To facilitate assembly <input type="checkbox"/> Part standardization	<input type="checkbox"/> Vendor change <input checked="" type="checkbox"/> To improve reliability <input type="checkbox"/> Other	<input type="checkbox"/> To meet standards ( )

To improve paper alignment in staple mode, the shapes of the front and rear jogger fences have been changed.

Old part number	New part number	Description	Q'ty	Int	Page	Index	Note
A3003611	B3124155	Front Jogger Fence	1	X/O	11	19	
A3003621	B3124150	Rear Jogger Fence	1	X/O	11	18	

